

CABLE GLANDS

Polyamide, IP68



Polyamide cable gland with strain relief, black
Temperature range: -25°C to 100°C

Metric Thread	Cable diameter (mm)	Width across flat (mm)	Length of thread (mm)	Part Number
M16 x 1.5	4 - 10	20	8	V20-GEI-M16PA(BLK)
M20 x 1.5	7 - 14	27	9	V20-GEI-M20PA(BLK)
M25 x 1.5	9 - 16	28	11	V20-GEI-M25PA(BLK)

Polyamide, spiral



Polyamide cable gland with spiral top to avoid cable buckling, black
Temperature range: -25°C to 100°C

M16 x 1.5	4.5 - 10	22	10	V20-GEI-M16PA SPIRAL (BLK)
M20 x 1.5	7.0 - 13	27	10	V20-GEI-M20PA SPIRAL (BLK)
M25 x 1.5				V20-GEI-M25PA SPIRAL (BLK)

Brass, IP68



Brass nickel-plated cable gland with strain relief, completely insulated, watertight with o-ring at external thread
Temperature range: -30°C to 120°C

M12 x 1.5	3 - 6.5	14	5	V20-GEI-M12
M16 x 1.5	5.5 - 10	17	5.5	V20-GEI-M16
M20 x 1.5	8 - 13	22	6	V20-GEI-M20
M25 x 1.5	11 - 18	30	7	V20-GEI-M25
M32 x 1.5	15 - 21	34	8	V20-GEI-M32

EMC Brass, IP68



Brass nickel-plated EMC-cable gland, for shielded cable with strain relief, completely insulated, watertight with o-ring on external thread
Temperature range: -30°C to 120°C

M12 x 1.5	3 - 6.5	14	5	V20-GEI-M12 EMC
M16 x 1.5	5.5 - 10	17	5.5	V20-GEI-M16 EMC
M20 x 1.5	8 - 13	22	6	V20-GEI-M20 EMC
M25 x 1.5	11 - 18	30	7	V20-GEI-M25 EMC
M32 x 1.5	15 - 21	34	8	V20-GEI-M32 EMC

BLANKING PLUG WITH O-RING

Polyamide

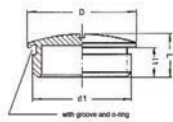

Polyamide blanking plug, glass-fibre reinforced with groove and o-ring with strain relief, grey
Temperature range: -25°C to 100°C

Metric Thread	D (mm)	L (mm)	L1 (mm)	Part Number
M16 x 1.5	22	10	6	V20-GEI-M16 PA BLANKING PLUG
M20 x 1.5	25	10	6	V20-GEI-M20 PA BLANKING PLUG
M25 x 1.5	31	11.5	7	V20-GEI-M25 PA BLANKING PLUG
M40 x 1.5	48	14	9	V20-GEI-M40 PA BLANKING PLUG
M63 x 1.5	70	18	12	V20-GEI-M63 PA BLANKING PLUG

Brass

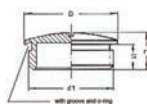

Brass nickel-plated blanking plug with groove and o-ring

M16 x 1.5	18	8	5	V20-GEI-M16 BLANKING PLUG
M20 x 1.5	25	9.5	6	V20-GEI-M20 BLANKING PLUG
M25 x 1.5	28	11	7	V20-GEI-M25 BLANKING PLUG
M32 x 1.5	35	12	8	V20-GEI-M32 BLANKING PLUG
M40 x 1.5	44	13	8	V20-GEI-M40 BLANKING PLUG
M50 x 1.5	54	15	9	V20-GEI-M50 BLANKING PLUG
M63 x 1.5	67	16	10	V20-GEI-M63 BLANKING PLUG

ACCESSORIES

Polyamide locknut

Polyamide locknut, glass-fibre reinforced, black



Metric Thread	SW (mm)	Thickness (mm)	Part Number
M16 x 1.5	22	5	V20-GEI-M16LOCK NUT (BLK)
M20 x 1.5	26	6	V20-GEI-M20LOCK NUT (BLK)
M25 x 1.5	32	6	V20-GEI-M25LOCK NUT (BLK)

O-Ring

O-ring made of perbunane, resistant to oils, ozone protected
Temperature range: -40°C to 140°C



Metric Thread	Inner Diameter (mm)	Outer Diameter (mm)	Thickness (mm)	Part Number
M16 x 1.5	13	16	1.5	V20-GEI-O Ring M16 x 1.5
M20 x 1.5	16	19	1.5	V20-GEI-O Ring M20 x 1.5
M25 x 1.5	22	26	2.0	V20-GEI-O Ring M25 x 1.5

Brass Enlarger

Brass nickel-plated enlarger, metric

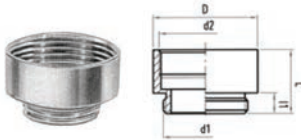

		D (mm)	L (mm)	L1 (mm)	Part Number
M16 x 1.5	M20 x 1.5	22	17.5	5	V20-GEI-M16-M20 ENLARGER
M20 x 1.5	M25 x 1.5	27	20	6	V20-GEI-M20-M25 ENLARGER
M25 x 1.5	M32 x 1.5	34	22.5	7	V20-GEI-M25-M32 ENLARGER
M32 x 1.5	M40 x 1.5	42	24.5	8	V20-GEI-M32-M40 ENLARGER
M40 x 1.5	M50 x 1.5	52	27.5	8	V20-GEI-M40-M50 ENLARGER

Brass Reducer

Brass nickel-plated reducer, metric

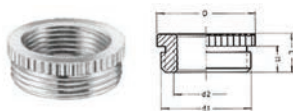

		D (mm)	L (mm)	L1 (mm)	Part Number
M20 x 1.5	M16 x 1.5	22	9	6	V20-GEI-M20-M16 REDUCER
M25 x 1.5	M16 x 1.5	27	10	7	V20-GEI-M25-M16 REDUCER
M25 x 1.5	M20 x 1.5	27	10	7	V20-GEI-M25-M20 REDUCER
M32 x 1.5	M20 x 1.5	34	11	8	V20-GEI-M32-M20 REDUCER
M32 x 1.5	M25 x 1.5	34	11	8	V20-GEI-M32-M25 REDUCER

Adaptor, PG to metric

Brass nickel-plated adaptor

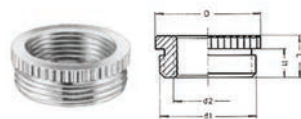

PG	Metric thread	D (mm)	L (mm)	L1 (mm)	Part Number
11	M20 x 1.5	22	16	6	V20-GEI-PG11-M20 PG TO METRIC
13.5	M20 x 1.5	24	16.5	6.5	V20-GEI-PG135-M20 PG TO METRIC
16	M20 x 1.5	24	9.5	6.5	V20-GEI-PG16-M20 PG TO METRIC
21	M25 x 1.5	30	10	7	V20-GEI-PG21-M25 PG TO METRIC
29	M25 x 1.5	39	11.5	8	V20-GEI-PG29-M25 PG TO METRIC

Adaptor, metric to PG

Brass nickel-plated adaptor

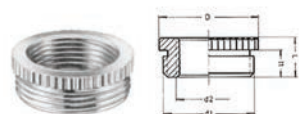

Metric thread	PG	D (mm)	L (mm)	L1 (mm)	Part Number
M25 x 1.5	11	27	10	7	V20-GEI-M25-PG11 METRIC TO PG
M25 x 1.5	13	27	10	7	V20-GEI-M25-PG13. METRIC TO PG
M25 x 1.5	16	27	10	7	V20-GEI-M25-PG16 METRIC TO PG
M32 x 1.5	21	34	11	8	V20-GEI-M32-PG21 METRIC TO PG

Note: Other size styles and accessories available upon request.